



CONTINENTAL  
TOWERS

# A NEW WORK DAY



# A new work day starts here.

Continental Towers has been re-envisioned, bringing an ultra-modern amenity package to this 910,000-square-foot office complex. Comprised of three, 12-story towers, the property is surrounded by over one acre of outdoor live-work-play space — the largest in the Chicago suburbs.

Experience a modern work environment with wide open spaces for collaborating and connecting. Continental Towers offers tenants a new workday, everyday.

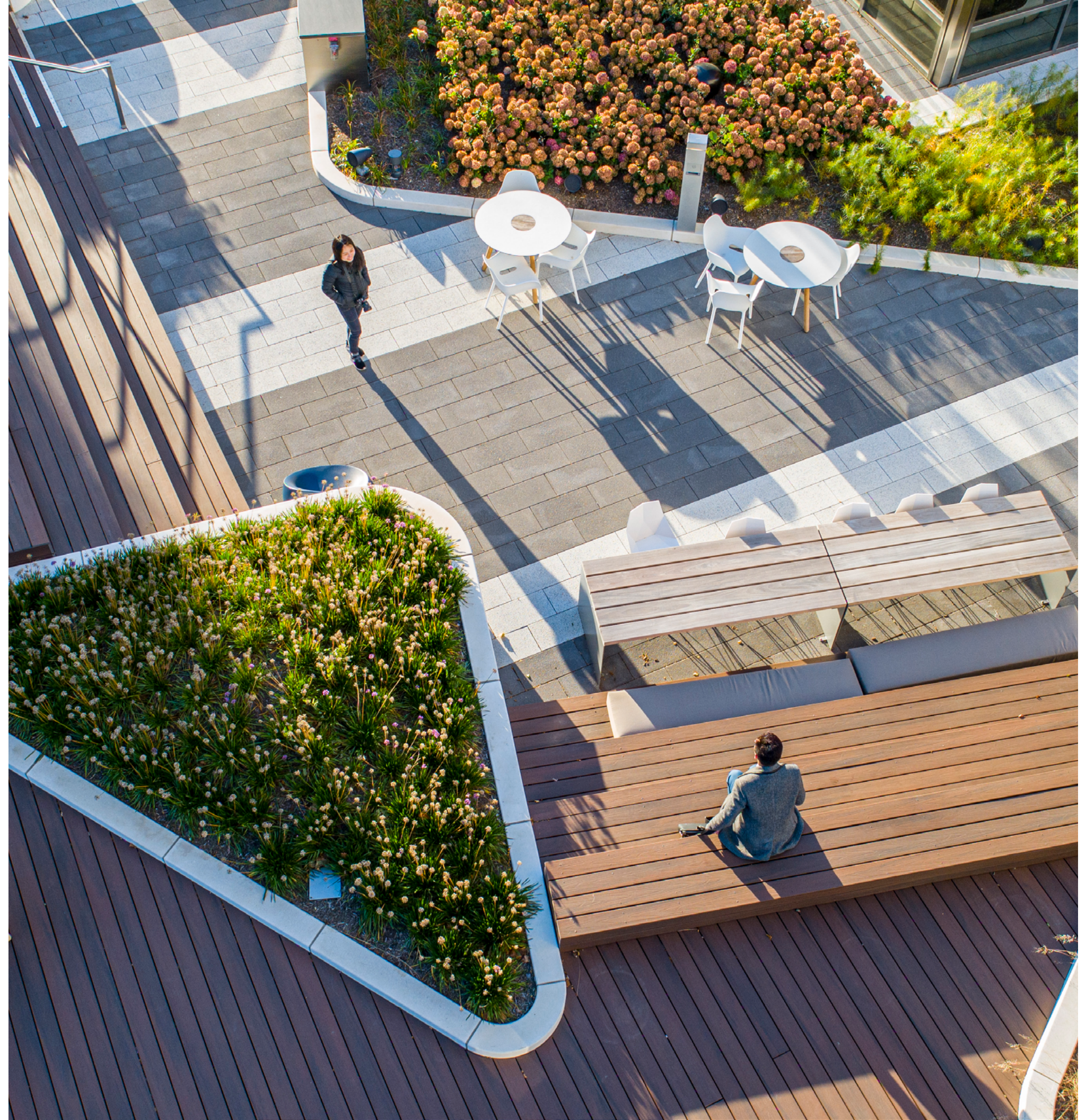

Outside Officing

# The Deck & The Meadows

Our sprawling outdoor space is so large we divided it into two sections. With over one full acre, it's the largest of its kind in the Chicago suburbs. The Deck and the Meadows are open all day for tenants to take advantage of working and meeting outdoors.



^  
The Meadows, a nod to our location in Rolling Meadows, is a large grassy area featuring lounge chairs and farm tables. It is the perfect location for an outdoor workout class.



>  
The Deck offers a barbecue area with multi-level stadium seating, gathering areas, fire pits, couches and outdoor games. Just like your backyard.



Creating Social Networks

# CT Social Club

A room with a view. CT Social Club is the social hub of the property and buzzes with activity all day. With a view to the outdoors, it's a place for meals, meetings, working, or a social gathering. On chilly days, grab a seat by the fireplace to warm up.



^  
The bird is a symbol of freedom and endless possibilities — the perfect visual reference for busy social interactions, which is why we chose it for the logo.



>  
Meet, connect, network. CT Social is open all day. The adjacent café serves up made-to-order meals for breakfast and lunch.

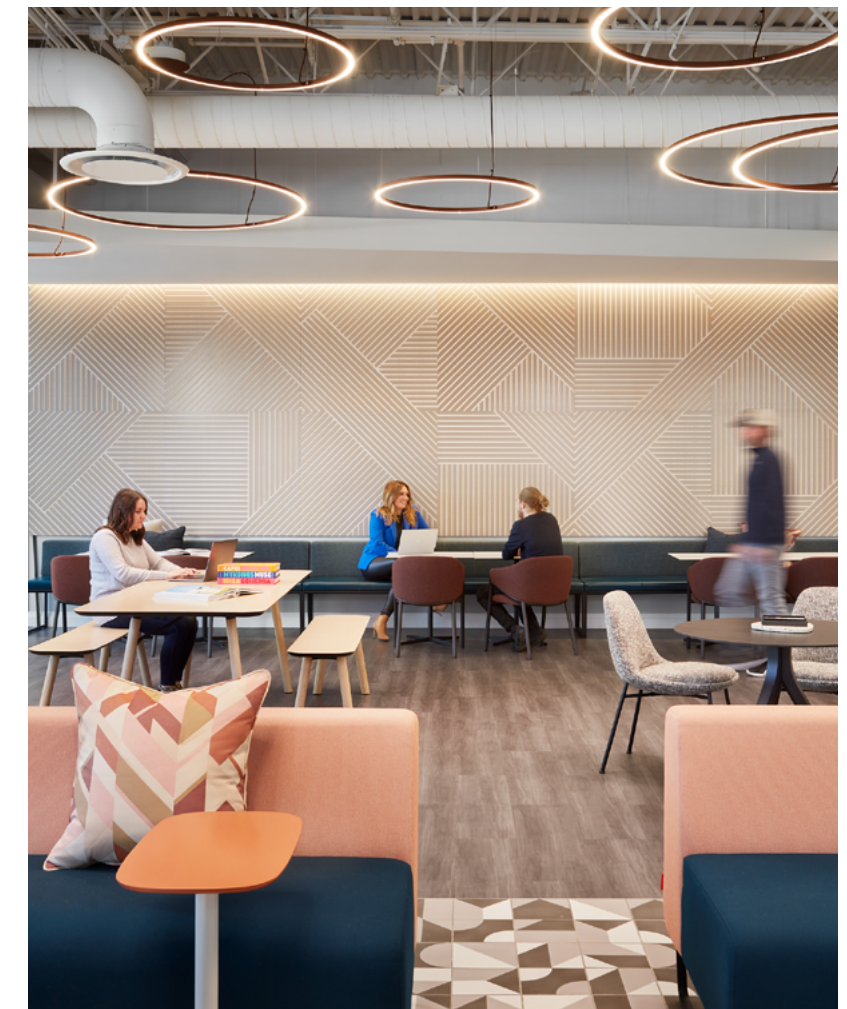

Stay & Play

# The Game Room

This is the spot for tenants who love a little friendly competition. Pool, ping pong, shuffle board and foosball tables fill the room. Board games fill the tables. Open all day long, tenants can come by on their lunch break or after work.



With the tagline 'stay and play' tenants are free to listen to music or play a game solo or with others. Open all day.



Located just off the Hub, the central meeting point of the buildings.



Wellness at Work

# CT Health Club

Our 23,000-square-foot health club offers state-of-the-art equipment with new locker rooms, towel service and designated spin and yoga classrooms.



◀ OPENING SOON

Two full-sized basketball courts will be open on a first-come, first-serve basis.



◀ OPENING SOON

One pickleball court will be open on a first-come, first-serve basis.



◀ OPENING SOON

A new state-of-the-art golf simulator will offer a combination of technologies designed to simulate a real-world golfing experience. Analyze your swing, make adjustments and even consult a golf pro.



# Conference Center – Town Hall

Our conference center and training facility is located off the lobby in Tower 3. It offers up to 4,000 square feet of flexible meeting spaces throughout four rooms, accommodating groups of up to 224 people.



# Ideal Floorplate

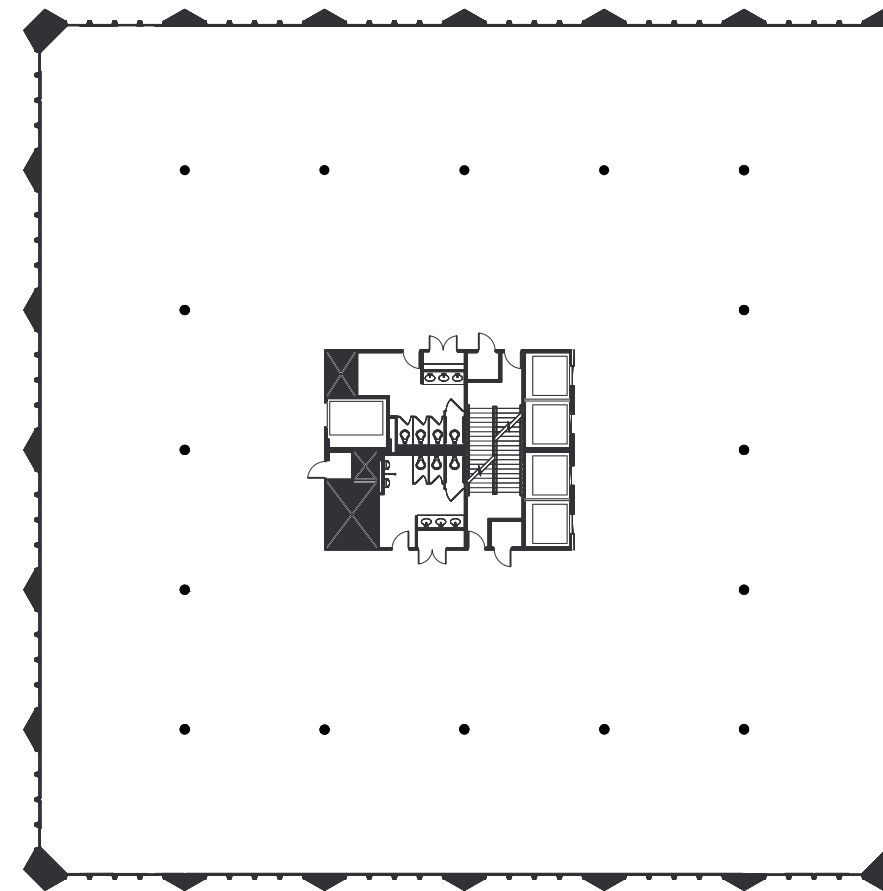

Our highly efficient square floorplate and small building core allow for maximum flexibility for furniture configurations. Floor-to-ceiling windows allow for abundance of natural light. Our column spacing is 25' x 25'.



Get Here from Anywhere

# Location

Continental Towers is conveniently located in Rolling Meadows, with excellent access to Northwest Tollway / I-90 and I-290. We are close to major tollways and accessible from all directions.

## ● FROM THE NORTH

From Route-53 exit on Algonquin Road; turn left onto Algonquin Road; turn right on New Wilke Road to the property.

## ● FROM THE WEST

From I-90 exit at IL-53; exit on Algonquin Road and turn left onto Algonquin Road; turn right on New Wilke Road to the property.

## ● FROM THE SOUTH

I-290 / Route-53 exit Algonquin Road; turn left onto Algonquin Road; turn right onto New Wilke Road to the property.

## ● FROM THE EAST

From I-90 exit at Arlington Heights Road; turn right onto Arlington Heights Road; turn left onto Algonquin Road; turn left onto either Golf Road or Meijer Road to the property.

Three signalized entrances to the property allow easy access from all directions. Two right-in right-outs along Golf Road

A Pace Bus stop located in front of the property along Golf Road. Nearby Metra stops are also accessible with our free Last Mile Lyft program.

The property is located less than 10 miles from O'Hare International Airport with plenty of nearby lodging to accommodate business travel.

Woodfield Mall is two miles west, giving tenants the convenience and amenities of the mall without the congestion and traffic in the immediate area.

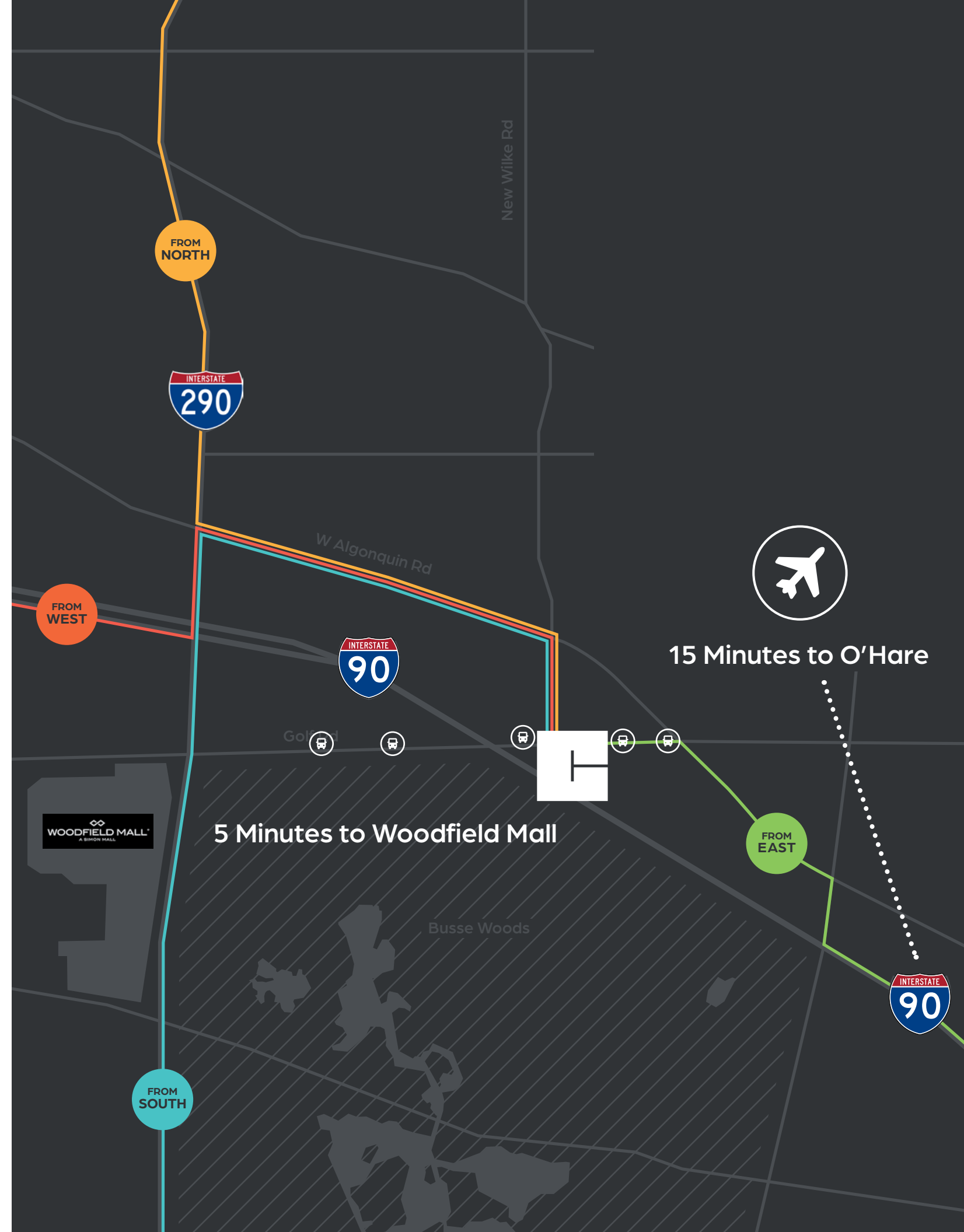



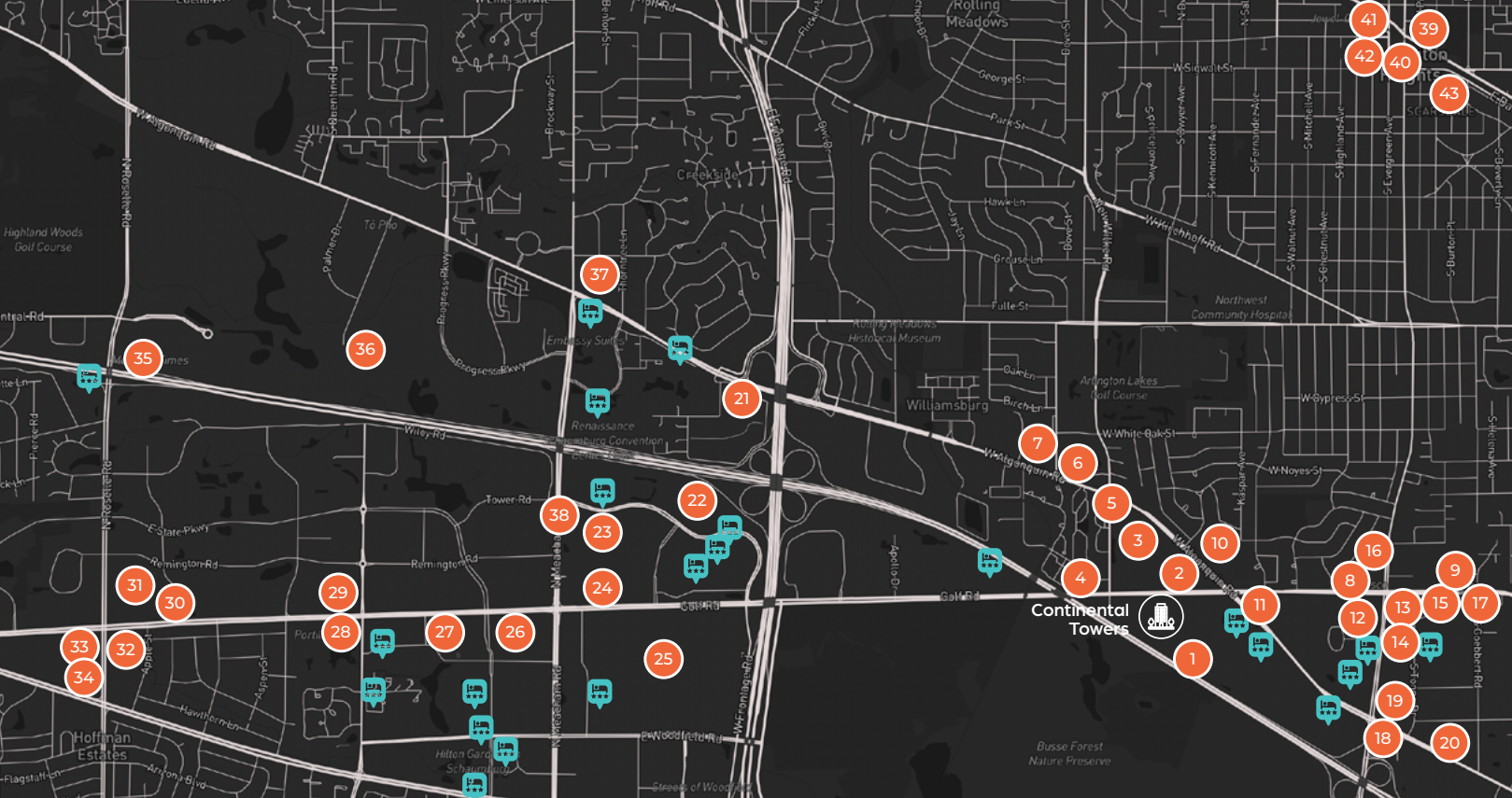

# Retail Map

- |   |   |  |
|---|---|--|
| 1. Meijer   | 20. Nikko Sushi   | 31. <b>SCHAUMBURG CORNERS:</b><br>Crumbi Cookie, H-Mart<br>Schaumburg, Lee's Hair Care,<br>Torizen, Tous Les Jour, Amazon<br>Fresh |
| 2. MingHin Cuisine  | 21. Moretti's, La Charanga Mexican<br>Restaurant  | 32. Jewel-Osco   |
| 3. Walmart  | 22. IKEA  | 33. Golf Center, T.J. Maxx   |
| 4. Portillo's   | 23. Costco Wholesale  | 34. Royal Buffet   |
| 5. Chef Ping  | 24. Trader Joe's  | 35. Medieval Times   |
| 6. Penang Malaysian Cuisine   | 25. <b>WOODFIELD MALL:</b>  | 36. Top Golf   |
| 7. Taqueria Los Laureles  | <a href="#">CLICK FOR MALL DIRECTORY</a>  | 37. Nawabi Hyderabad House   |
| 8. Jewel-Osco   | 26. <b>WOODFIELD COMMONS</b>  | 38. Wildberry Pancakes & Cafe  |
| 9. ALDI   | <b>EAST-WEST:</b> Fat Rosie's Taco<br>& Tequila Bar, Egg Harbour,<br>PGA TOUR Superstore, Weber<br>Grill Restaurant, Hobby Lobby,<br>Value City | 39. Gumrai Thai  |
| 10. Lowe's Home Improvement   | 27. McDonald's & Chick-Fil-A  | 40. Chase  |
| 11. Cooper's Hawk   | 28. Portillo's & Barnelli's   | 41. Jewel-Osco   |
| 12. <b>ARLINGTON TOWN SQUARE:</b><br>Dollar Tree, Pet Supplies Plus,<br>Bank of Hope, Jett's Pizza,<br>Kaido Sushi, Simply Nails Spa,<br>Asian Bistro | 29. <b>WOODFIELD PLAZA:</b> Blick Art<br>Materials, McAllister's Deli, SGD<br>Tofu, Tropical Smoothie Cafe,<br>Planet Fitness                   | 42. Shakou Restaurant, Mago Grill<br>& Cantina, Peggy Kinnane's Irish<br>Restaurant & Pub, La Tasca<br>Tapas                       |
| 13. Walgreens, Toe Paradise,<br>Golden Brunch, Cuisina Italiana   | 30. Outback Steakhouse, Yu's<br>Mandarin  | 43. Mochinut, Alt-Thai, Passero,<br>CoCo & Blu, Salsa 17   |
| 14. Johnnie's Beef  |   |  |
| 15. Chase Bank  |   |  |
| 16. Starbuck's  |   |  |
| 17. McDonald's  |   |  |
| 18. Guitar Center   |   |  |
| 19. Mitsuwa   |   |  |

 Hotels & Convention Centers





**C O N T I N E N T A L**  
T O W E R S

1701 Golf Road  
Rolling Meadows, IL 60006

**FOR LEASING INFORMATION:**

**JOE STEVENS**

847.840.8743

[joe.stevens@transwestern.com](mailto:joe.stevens@transwestern.com)

**STEVE DEGODNY**

312.593.5991

[steve.degodny@transwestern.com](mailto:steve.degodny@transwestern.com)

